

LuxnaControl APP Gateway Kit Installation Instructions



Please read these instructions carefully before installation
Leave a copy for the user/maintenance engineer for future reference

Download the LUXNAControl APP for iOS or Android.
Link to your smartphone or tablet using the LUXNA APP Gateway Kit via your network connection.
Visit the website for further details and setup information.

| Part No. | Description |
|------------|-----------------|
| LXFRD10/GW | APP Gateway Kit |

Quick Setup Guide

- This LUXNA APP Gateway Kit is for use with LUXNA Lighting APP LED Downlights – Part No. LXFRD10APP
- Using the pack contents supplied, follow the diagram below to install the LUXNA APP Gateway Kit and connect to your network router.
- Please observe the recommended maximum distances between products for secure connection.
- The first APP Downlight in the room should be installed within 10 metres of the APP Gateway location.
The distance between the last APP Downlight and the first App Downlight in adjacent rooms should be less than 5m.
- The maximum number of APP Downlights which can be connected to 1 APP Gateway is 200. Additional APP Gateway Kits can be connected to expand the system if required.

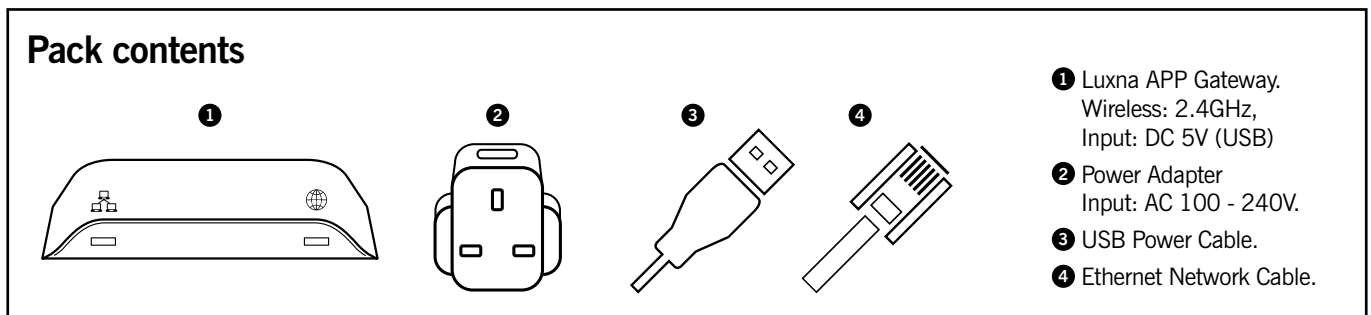
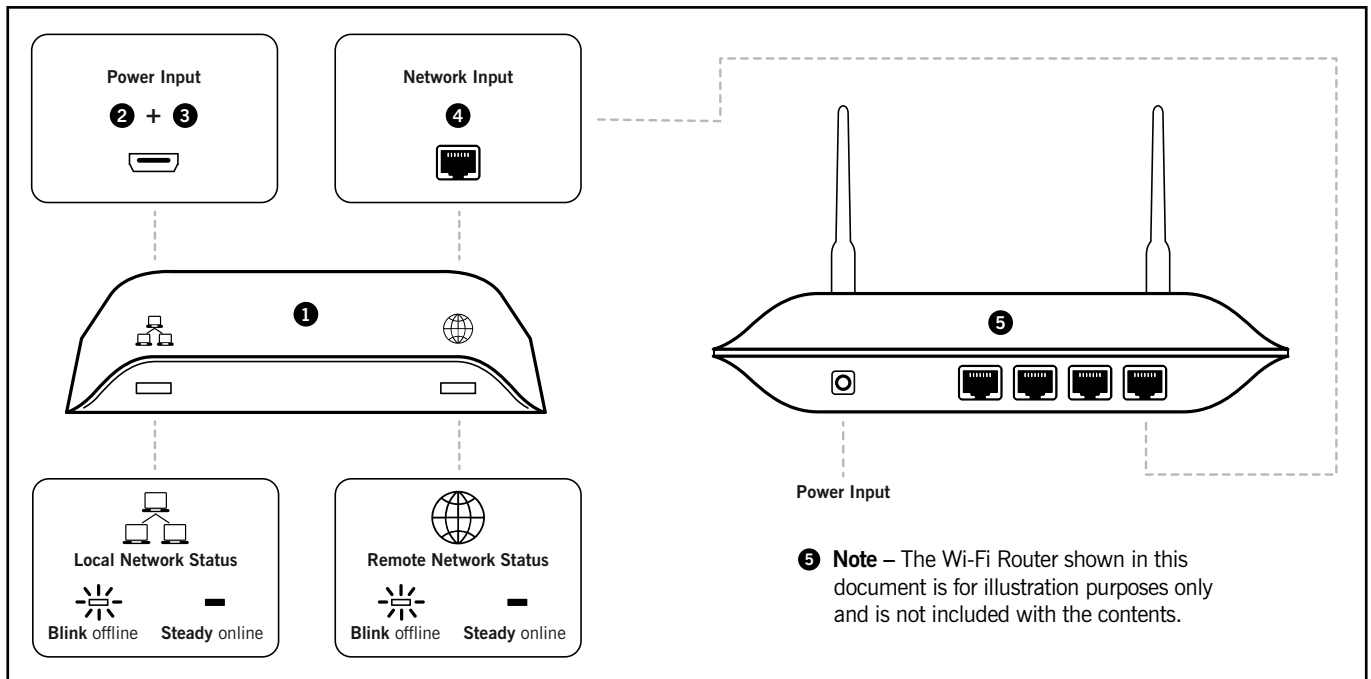

Quick User Guide

- Check that all LUXNA LED APP Downlights are installed and operating correctly.
- Ensure that the Wi-Fi Router (not supplied) is connected to the internet. This will provide the network hub within the room.
- Install the LUXNA APP Gateway Kit and connect to the internet via the network router.
- Connect your smartphone or tablet device to the same Wi-Fi signal as the network hub, which is connected to the Gateway.
- Download and install the LUXNAControl APP from the website: www.luxna-lighting.com
- Open the LUXNAControl APP and click the registration screen to setup a new account.
- Login to the account and confirm that a new Gateway has been detected.
- After adding the Gateway select the room which is to be paired.
- Click the add button in the room screen and then select the Lighting control.
- Lock the settings and names for the room and controller, then click Done.
- Click the Match button in the Controller interface and select from 1 of the 4 channels. Using the wall switch, turn off the power to the APP Downlights which are to be controlled then switch back on again within 1 second.
- The APP Downlights will flash 3 times slowly to confirm successful matching, then click Back to return to the Controller interface screen.
- You can now use the functions of the APP to control the LUXNA APP Downlights.



LuxnaControl APP

Feature Highlights

- Use in the home to dim the light intensity and change the colour temperature, creating beautiful moods and ambiance to suit your personal taste.
- Use in any commercial application including hotels, restaurants and offices to stimulate the senses and add style to the architectural surroundings.
- Adjustable LED light intensity with a standard dimming range from 100% to 5% including Night Light mode which is 2% of the maximum brightness.
- Control the colour temperature of the LED lighting with ease, choose from:
 - 1). Warm White 3000K – Perfect for promoting relaxation whilst creating a friendly or intimate setting.
 - 2). Neutral White 4000K – For a natural ambiance to compliment décor and enhance interior features.
 - 3). Cool White 6000K – Be alert and increase productivity. Ideal for a Clean, fresh energising feel.
- Define and name rooms, create user specific spaces and scenes.
- Control lights individually, in groups or select from pre-set scenes such as Read, Party, Movie, Eat and Return Home Mode.
- Expand the usability of the system by adding other electrical devices linked via the LUXNA APP Gateway.
- Easy to use, simple to install and setup.

Visit the website for APP download and full setup information

Guarantee

This product is guaranteed in the EU for a period of 2 years from the date of purchase. The guarantee is invalid in the case of improper use, installation, tampering, removal of the QC/batch code label, or use in an improper working environment. Should this product fail during the guarantee period it will be replaced free of charge, subject to correct installation and return of the faulty unit. Luxna Lighting does not accept responsibility for any installation costs associated with the replacement of this product. Your statutory rights are not affected. Luxna Lighting reserves the right to alter product specifications without prior notice.